

Sunnata Advanced Features Mode (AFM)

Sunnata Models

[en español / en français](#)

STCL-153P

Overview

Sunnata dimmers contain an Advanced Features Mode (AFM) that allows users to customize the control to meet their specific needs. This document serves as a supplement to the Sunnata installation instructions. Before entering AFM, it is important to have a good understanding of the advanced features.

Easily adjust your dimmer in 5 steps:

1. Enter AFM
2. Select the feature you want to change
3. Change the feature
4. Save the setting
5. Exit AFM

For instructional videos on how to adjust features, visit www.lutron.com/sunnatasupport

Dimmer

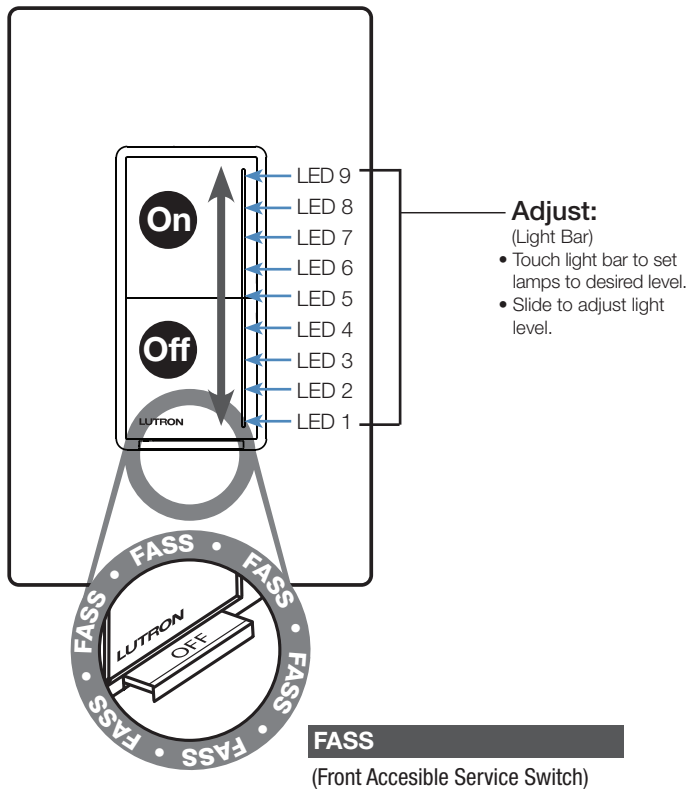

Glossary:	2
High-End Trim: Adjust the maximum light level of the load. . .	3
Low-End Trim: Adjust the minimum light level of the load. . .	4
Using AFM:	5
Preset Light Level: Change the behavior of the device when the ON button is pressed from the OFF state to ON. . .	8
Light Bar Brightness: Select between high, medium, and low brightness of the control's light bar.	11
Light Level Indicator/Nightlight: Select between ON and OFF for the Light Bar when not interacting with the control. . .	14
Restore Factory Default Settings: Return the control to its original settings.	17

Default Settings

Feature	Default
High-end trim	Highest level of trim range
Low-end trim	Middle level of trim range
Light level indicator/Nightlight	ON/ON
Light bar brightness	Medium brightness
Preset light level	Tapping the ON button always sets the lights to full (locked preset at high-end)

Glossary

Change Feature Mode	Allows the user to modify the selected feature.
Default Setting	The way the feature operates when the control is first used.
Factory Default	The way all the features operate when the control is first used.
FASS	Tab at bottom of control, required to be pulled out for light bulb(s) replacement and entering <i>Advanced Features Mode (AFM)</i> ; also known as <i>Air Gap</i> .
Flashing Quickly	Light bar on the dimmer is flashing ~8 times per second. This indicates that the user has entered the Change Feature Mode .
Flashing Slowly	Light bar on the dimmer is flashing ~4 times per second. This indicates that the user has entered the Select Feature Mode .
High-End Trim	The highest achievable light level to which the control can be adjusted.
Light Level Indicator	The light bar is illuminated to display the current load level when the load is on and the control has not been touched for about 2 seconds.
Load	The light bulb(s) that the control is controlling.
Locked Preset	A programmable light level setting to which the control will turn on after tapping the ON button once.
Low-End Trim	The lowest achievable light level to which the control can be adjusted.
Nighlight	The entire light bar is faintly illuminated when the load is OFF.
Normal Operation	Standard use of control (ON/OFF, touch); indicator lights will not be flashing.
Press and Hold	Sustained activation of the ON/OFF button for a specified period of time.
Select Feature Mode	Allows the user to select the feature they are looking to modify.
Slide	Lightly make contact with the control and move finger up or down without depressing any buttons.
Tap	Momentary activation of the ON/OFF button. Less than 1 second.
Touch	Lightly make contact with the control but do not depress any buttons.
Unlocked Preset	A light level setting that allows the control to turn ON to the last dimmed setting when tapping the ON button once. The control stores the light level setting after remaining there for one second. When in the load is off, a single LED will glow brighter than the rest to indicate the saved level.

High-end Trim Shortcut

This feature allows the user to determine the maximum light level and adjust the settings accordingly. It is typically used to avoid undesirable lamp behavior near high-end or to reduce power consumption.

Default Setting: Highest level of trim range.

1. To enter **High-end Trim**, **touch** the top of the light bar continually **for about 6 seconds**. (DO NOT depress the ON button.)

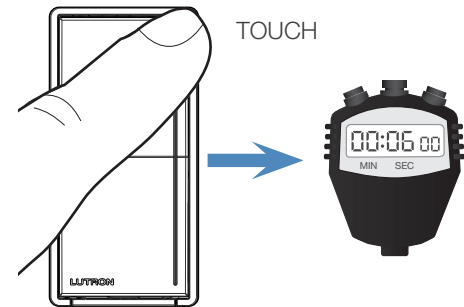

2. The device will go to high-end and the light bar will begin **flashing slowly** (~4 times/second). Remove your finger and the light bar will begin to **flash quickly** (~8 times/second) indicating the current high-end trim level.

Note: The control will automatically exit high-end trim mode **after 1 minute** of inactivity.

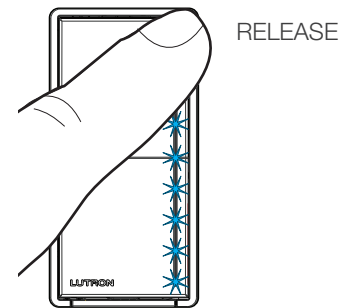

3. **Slide** your finger up or down the light bar to set the maximum light level (high-end). The trim setting follows your finger as it is adjusted.

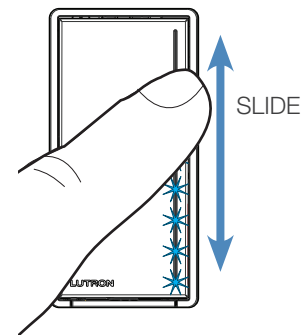

4. Once the maximum light level is acceptable, **Tap** the OFF button to confirm your setting and exit into **Normal Operation**.

Note: If at any time you are not happy with the settings you have achieved, you may [Restore Factory Default Settings](#). See page 17 for details.

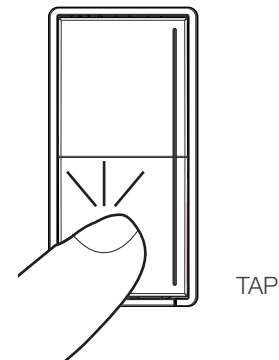

Low-end Trim Shortcut

This feature minimizes LED bulb flickering and strobing¹ when the dimmer is at the minimum light level. This feature can also be used to set a personal preference.

Default Setting: Middle level of trim range.

1. To enter **Low-end Trim**, **touch** the middle of the light bar continually **for about 6 seconds**. (DO NOT depress the ON or OFF button.)

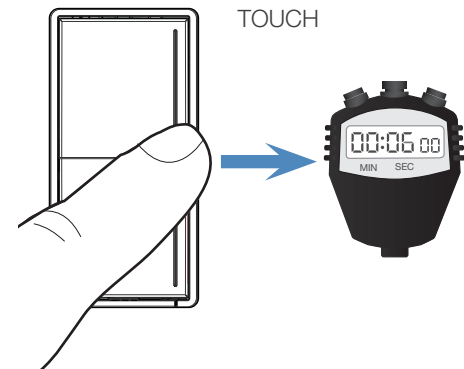

2. The device will go to low-end and the light bar will begin **flashing slowly** (~4 times/second). Remove your finger and the light bar will begin to **flash quickly** (~8 times/second) indicating the current low-end trim level.

Note: The control will automatically exit low-end trim mode **after 1 minute** of inactivity.

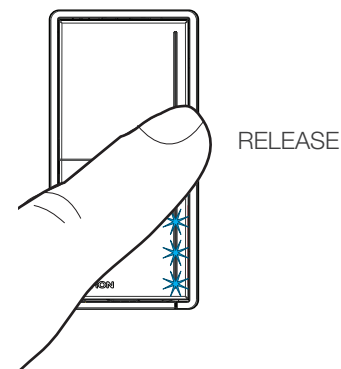

3. **Slide** your finger up or down the light bar to set the minimum light level (low-end). The trim setting follows your finger as it is adjusted.

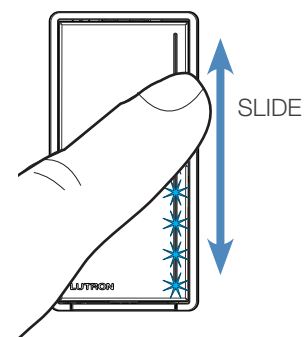

4. Once the minimum light level is acceptable, **Tap** the OFF button to confirm your setting and exit into **Normal Operation**.

Note: If at any time you are not happy with the settings you have achieved, you may [Restore Factory Default Settings](#).

See page 17 for details.

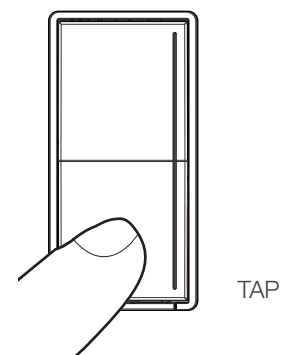

¹ Occurs when low-end trim is set too low for a given bulb's design capabilities, which can shorten lamp life.

Using AFM

AFM consists of two levels of operation:

1. **Select Feature Mode** allows the user to select the feature they are looking to modify.
2. **Change Feature Mode** allows the user to modify the feature that has been selected in **Select Feature Mode**.

Notes:

- Unless otherwise specified, the **AFM** settings are saved when the control transitions from **Change Feature Mode** to **Select Feature Mode**.
- The control will automatically exit **AFM** after 1 minute of inactivity.
- If the control automatically exits **AFM** while still in **Change Feature Mode**, the new setting will be saved.
- **AFM** cannot be entered from the 3-way switch in the other location.

Enter AFM

1. **Pull** the Front Accessible Service Switch (**FASS**) out to the OFF position.

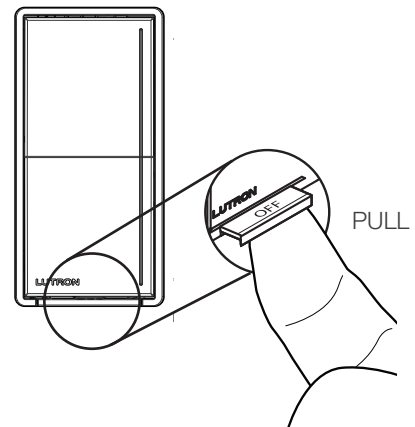

2. **Press and hold** the OFF button. (Press the left side of the button to not mistakenly affect the light bar.)

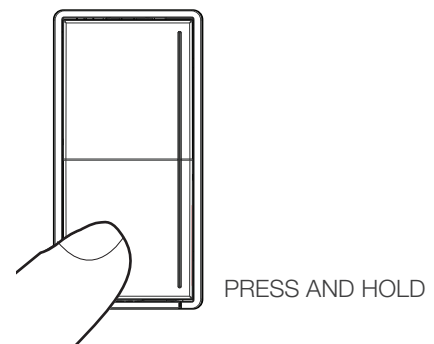

(continued on next page . . .)

Using AFM (continued)

Enter AFM (continued)

3. While continuing to **hold** the OFF button, **push** the Front Accessible Service Switch (FASS) in to the ON position. Continue to **hold** the OFF button for **approximately 6 seconds**.

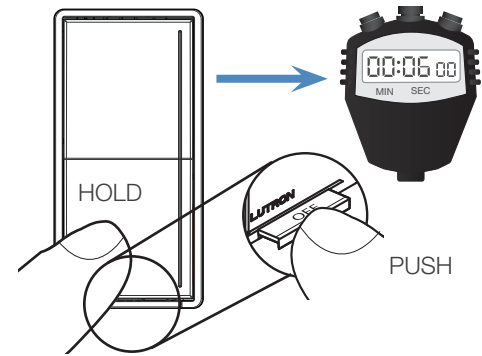

4. The light bar will be **flashing slowly** (~4 times/second). **Release** the OFF button and **LED 1** will continue to **flash slowly** (~4 times/second) to indicate entry into **AFM**.

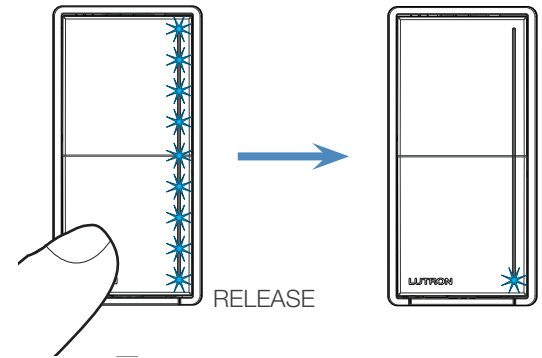

Enter Change Feature Mode

5. **Touch** the light bar near the LED that represents the feature to be modified (Example: LED 5 = light bar brightness.)

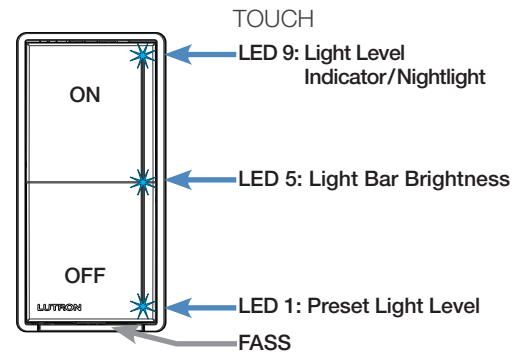

6. Confirm the selection by **Tapping** the OFF button. The selected feature can now be modified according to the appropriate feature menu starting on the next page.

Note: The LED for the selected setting will be **flashing quickly** (~8 times/second) to indicate that **Change Feature Mode** has been entered.

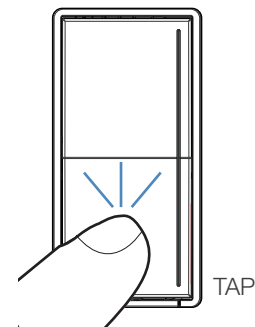

(continued on next page . . .)

Using AFM *(continued)*

Modify the Selected Feature

7. Make desired changes to the settings by following the steps outlined later in this document.
8. **Tap** the OFF button to save the setting and exit back to the **Select Feature Mode**.

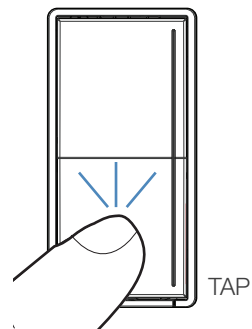

Exit AFM

9. **Press and hold** the OFF button **for approximately 6 seconds**.
 - The load will go to the previous ON level.
 - Light bar will return to **Normal Operation**.

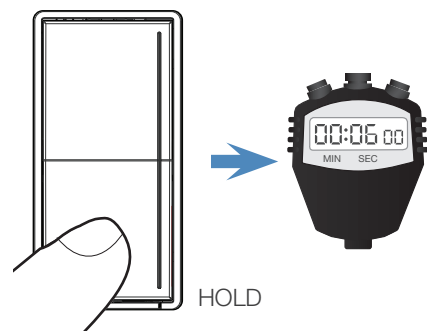

Preset Light Level

Change the behavior of the device when the ON button is pressed from the OFF state.

- **Unlocked Preset (Last Level Preset)** indicates that the device will come ON to its last ON level prior to turning OFF. This level is indicated by an LED that glows brighter in the nightlight state.
- **Locked Preset** indicates that the device will come ON to a user specified level.

Default Setting: Tapping the ON button always sets the lights to full (Locked Preset at High-end).

Enter AFM

1. **Pull** the Front Accessible Service Switch (**FASS**) out to the OFF position.

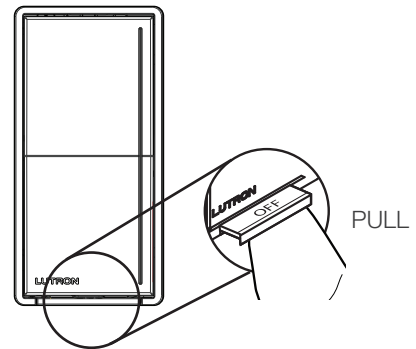

2. **Press and hold** the OFF button. (Press the left side of the button to not mistakenly affect the light bar.)

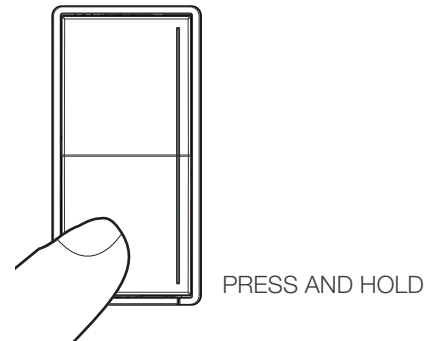

(continued on next page . . .)

Preset Light Level *(continued)*

Enter AFM *(continued)*

3. While continuing to **hold** the OFF button, **push** the Front Accessible Service Switch (**FASS**) in to the ON position. Continue to **hold** the OFF button **for approximately 6 seconds**.

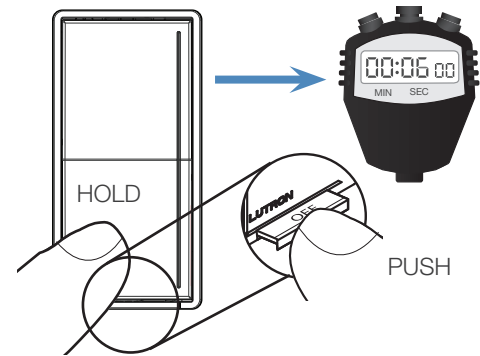

4. The light bar will be **flashing slowly** (~4 times/second). **Release** the OFF button and **LED 1** will continue to **flash slowly** (~4 times/second) to indicate entry into **AFM**.

Note: The control will automatically **exit AFM after 1 minute** of inactivity.

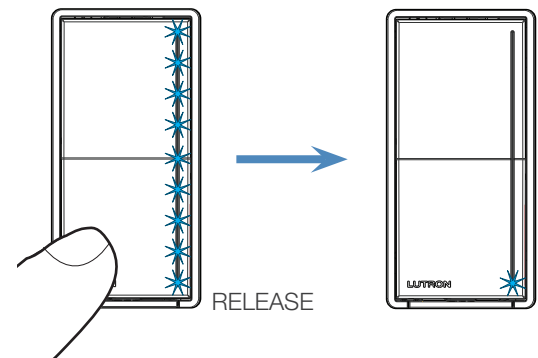

Enter Change Feature Mode

5. LED 1 **flashing slowly** (~4 times/second) while in the **Select Feature Mode** indicates that **Preset Light Level** is currently selected.

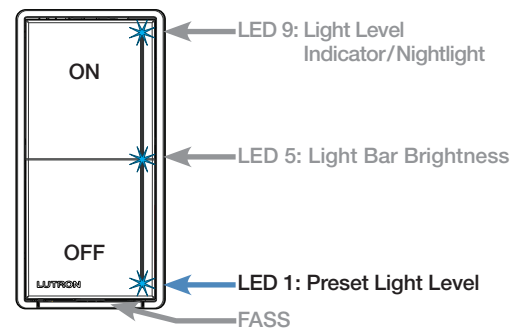

6. Confirm the selection by **Tapping** the OFF button. Some LEDs will be **flashing quickly** (~8 times/second) to indicate that **Change Feature Mode** has been entered.

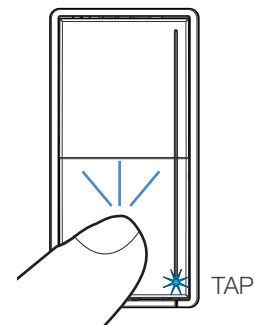

(continued on next page . . .)

Preset Light Level *(continued)*

Modify the Selected Feature

Choose either . . .

7. a. Unlocked Preset

Touch and hold the middle of the light bar for 6 seconds until the LEDs begin scrolling.

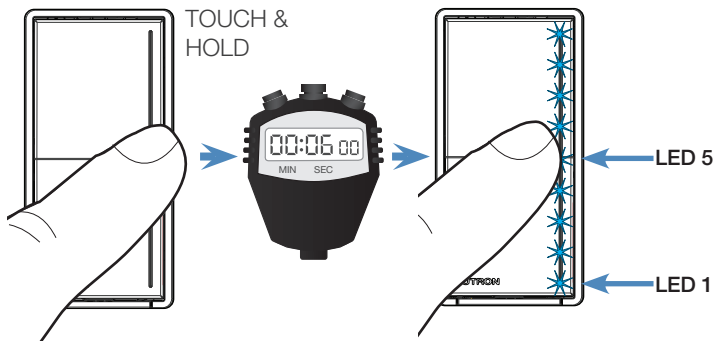

OR

b. Locked Preset

Touch any part of the light bar to select a preset to unlock. The light bar will be **flashing quickly** (~8 times/second) to indicate the protected preset light level.

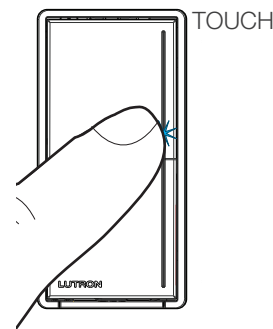

8. Tap the OFF button to confirm your settings and return to the **Select Feature Mode**. Now you may either make another **AFM** selection or **exit AFM**.

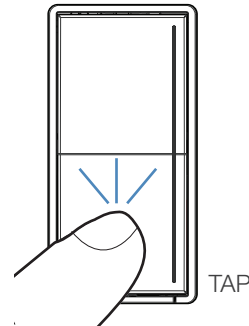

Exit AFM

9. Press and hold the OFF button for approximately 6 seconds to exit AFM and go back into **Normal Operation**.

Note: If at any time you are not happy with the settings you have achieved, you may [Restore Factory Default Settings](#). See page 17 for details.

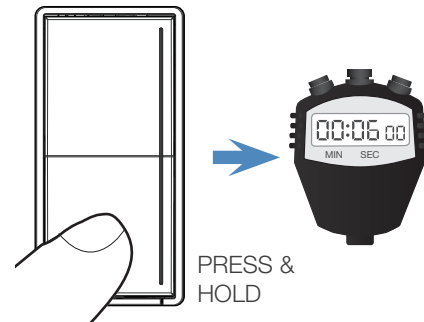

Light Bar Brightness Menu

Adjust the brightness of the LEDs on the light bar in the Active, Light Level Indicator, and Nightlight states.

Default Setting: Medium brightness

Enter AFM

1. **Pull** the Front Accessible Service Switch (**FASS**) out to the OFF position.

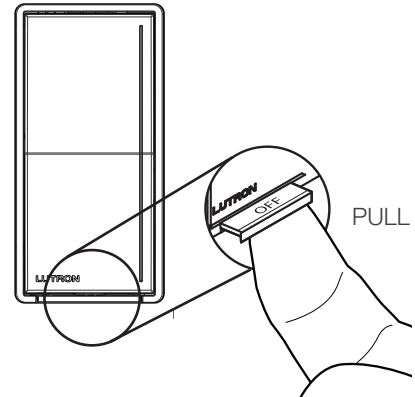

2. **Press and hold** the OFF button. (Press the left side of the button to not mistakenly affect the light bar.)

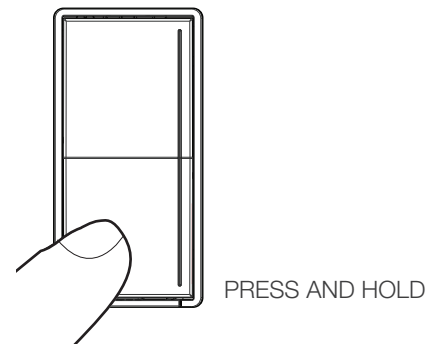

3. While continuing to **hold** the OFF button, **push** the Front Accessible Service Switch (**FASS**) in to the ON position. Continue to **hold** the OFF button **for approximately 6 seconds**.

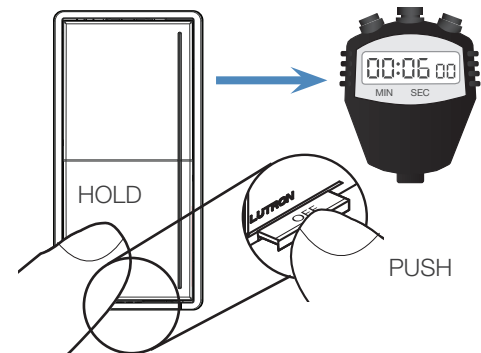

4. The light bar will be **flashing slowly** (~4 times/second). **Release** the OFF button and **LED 1** will continue to **flash slowly** (~4 times/second) to indicate entry into **AFM**.

Note: The control will automatically **exit AFM** after **1 minute** of inactivity.

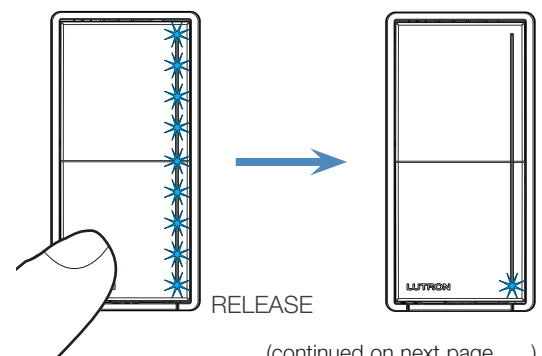

(continued on next page . . .)

Light Bar Brightness Menu *(continued)*

Enter Change Feature Mode

5. While in **Select Feature Mode**, select the **Light Bar Brightness** menu by **touching** LED 5.

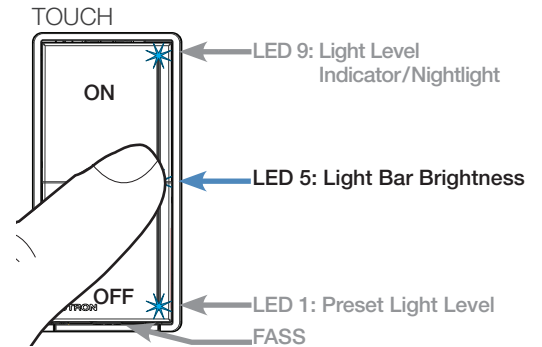

6. Confirm the selection by **Tapping** the OFF button. An LED will be **flashing quickly** (~8 times/second) to indicate that **Change Feature Mode** has been entered.

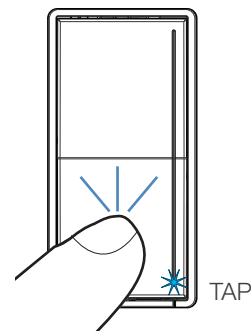

Modify the Selected Feature

7. **Touch** the light bar in the area of the LED corresponding to your selection.

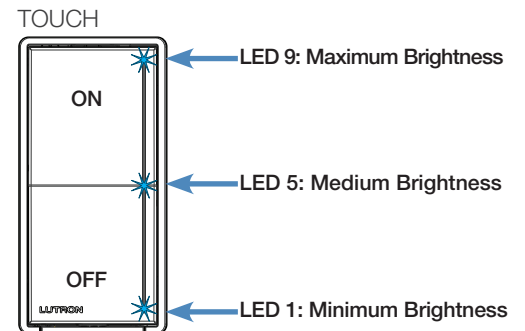

(continued on next page . . .)

Light Bar Brightness Menu *(continued)*

Modify the Selected Feature *(continued)*

8. Tap the OFF button to confirm your settings and return to the **Select Feature Mode**. Now you may either make another **AFM** selection or **exit AFM**.

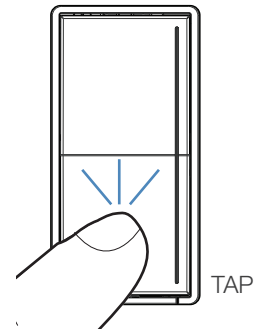

Exit AFM

9. Press and hold the OFF button for approximately 6 seconds to exit **AFM** and go back into **Normal Operation**.

Note: If at any time you are not happy with the settings you have achieved, you may [Restore Factory Default Settings](#). See page 17 for details.

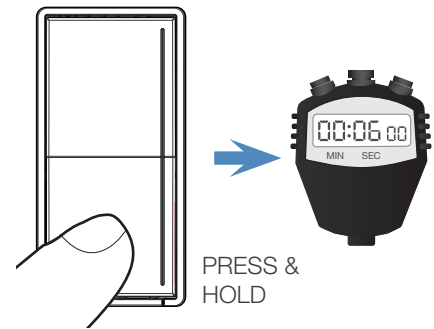

Light Level Indicator/Nightlight Menu

This feature can enable or disable the Light Level Indicator bar and the Nightlight light bar.

- **Light Level Indicator** - Light bar behavior when load is ON and it has not been touched for about 2 seconds.
- **Nightlight** - Light bar behavior when load is OFF.

Default Setting: ON/ON

Enter AFM

1. **Pull** the Front Accessible Service Switch (**FASS**) out to the OFF position.
2. **Press and hold** the OFF button. (Press the left side of the button to not mistakenly affect the light bar.)
3. While continuing to **hold** the OFF button, **push** the Front Accessible Service Switch (**FASS**) in to the ON position. Continue to **hold** the OFF button **for approximately 6 seconds**.
4. The light bar will be **flashing slowly** (~4 times/second). **Release** the OFF button and **LED 1** will continue to **flash slowly** (~4 times/second) to indicate entry into **AFM**.
Note: The control will automatically **exit AFM after 1 minute** of inactivity.

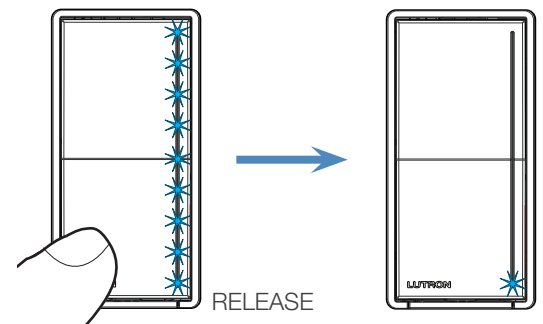
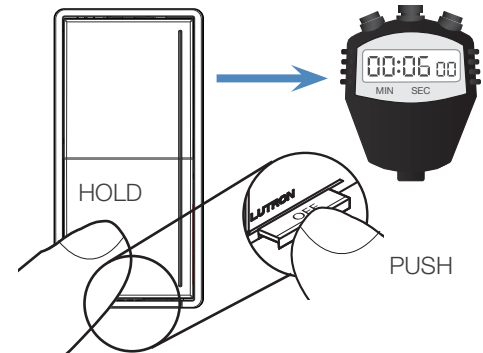
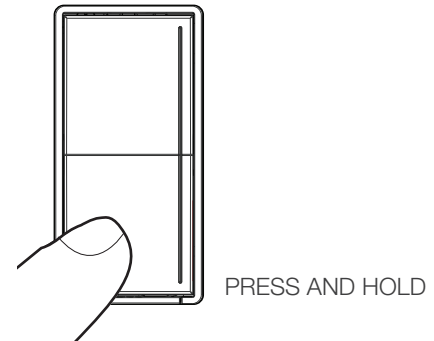
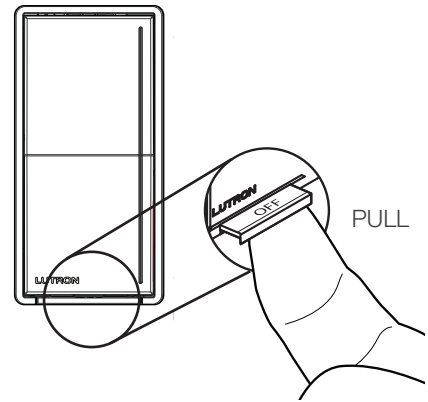

(continued on next page . . .)

Light Level Indicator/Nightlight Menu *(continued)*

Enter Change Feature Mode

5. While in **Select Feature Mode**, select the **Light Level Indicator/Nightlight** menu by **touching** LED 9.

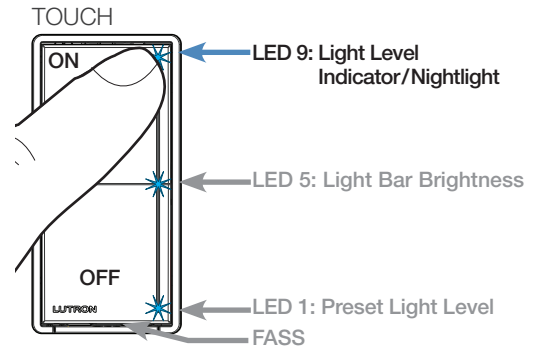

6. Confirm the selection by **Tapping** the OFF button. An LED will be **flashing quickly** (~8 times/second) to indicate that **Change Feature Mode** has been entered.

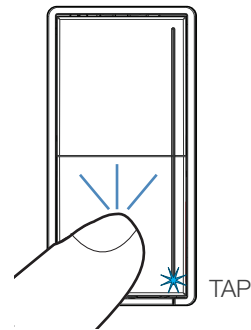

Modify the Selected Feature

7. **Touch** the light bar in the area of the LED corresponding to your selection.

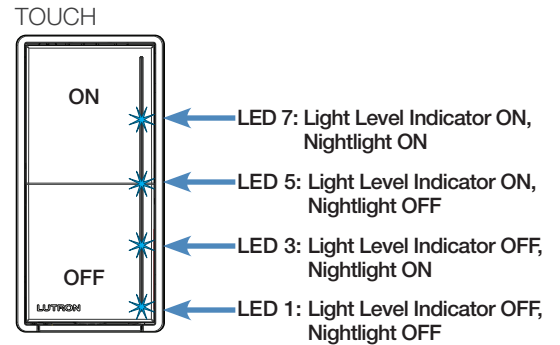

Light Level Indicator/Nightlight Menu *(continued)*

Modify the Selected Feature *(continued)*

8. Tap the OFF button to confirm your settings and return to the **Select Feature Mode**. Now you may either make another **AFM** selection or **exit AFM**.

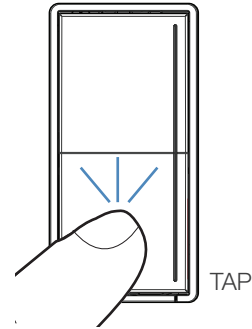

Exit AFM

9. Press and hold the OFF button for approximately 5 seconds to exit **AFM** and go back into **Normal Operation**.

Note: If at any time you are not happy with the settings you have achieved, you may [Restore Factory Default Settings](#). See page 17 for details.

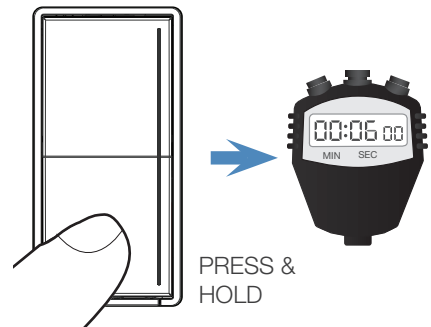

Restore Factory Default Settings

The dimmer can be returned to its original factory settings. This allows the customer a risk-free experience to try multiple setting styles without worry.

Default Settings

Feature	Default
High-end trim	Highest level of trim range
Low-end trim	Middle level of trim range
Light level indicator/Nightlight	ON/ON
Light bar brightness	Medium brightness
Preset light level	Tapping the ON button always sets the lights to full (locked preset at high-end)

1. **Triple tap** the OFF button **rapidly, holding** on the last press.
2. **Continue holding** until the light bar and the lighting load begin to **raise from low to high** in about 3 seconds.
3. Immediately triple **tap** the OFF button again and **release**.
4. The light bar and lighting load will begin to raise from low to high 3 times, the middle of the light bar flashes, the lights turn off and then turn back on to high-end.

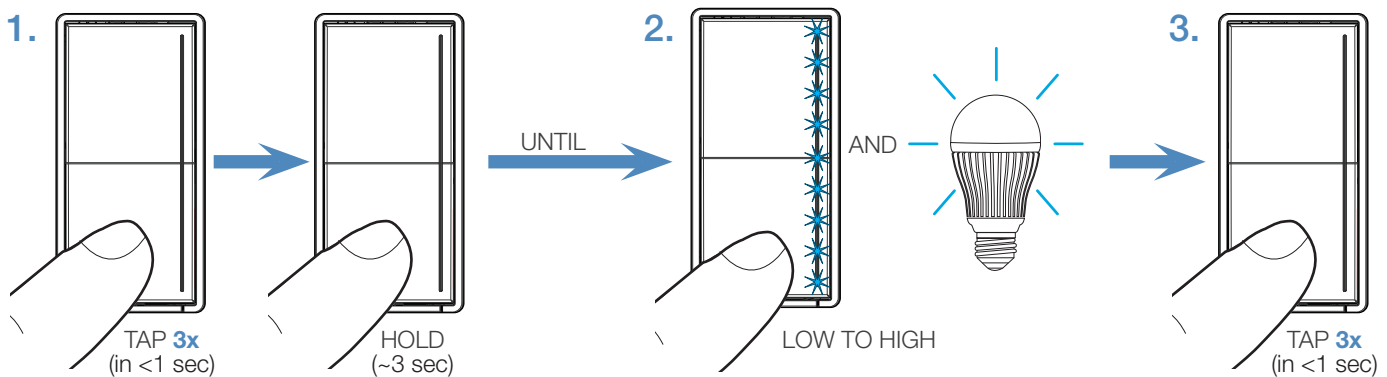

Lutron, FASS, LED+, and Sunnata are trademarks or registered trademarks of Lutron Electronics Co., Inc. in the US and/or other countries.

Lutron Contact Numbers

WORLD HEADQUARTERS

USA
Lutron Electronics Co., Inc.
7200 Suter Road
Coopersburg, PA 18036-1299
TEL: +1.610.282.3800
FAX: +1.610.282.1243
support@lutron.com
www.lutron.com/support

North & South America Customer Assistance

USA, Canada, Caribbean:
1.844.LUTRON1 (1.844.588.7661)
Mexico:
+1.888.235.2910
Central/South America:
+1.610.282.6701

UK AND EUROPE:

Lutron EA Limited
125 Finsbury Pavement
4th floor, London EC2A 1NQ
United Kingdom
TEL: +44.(0)20.7702.0657
FAX: +44.(0)20.7480.6899
FREEPHONE (UK): 0800.282.107
Technical Support: +44.(0)20.7680.4481
lutronlondon@lutron.com

ASIA:

Lutron GL Ltd.
390 Havelock Road
#07-04 King's Centre
Singapore 169662
TEL: +65.6220.4666
FAX: +65.6220.4333
Technical Support: 800.120.4491
lutronsea@lutron.com

Asia Technical Hotlines

Northern China: 10.800.712.1536
Southern China: 10.800.120.1536
Hong Kong: 800.901.849
Indonesia: 001.803.011.3994
Japan: +81.3.5575.8411
Macau: 0800.401
Taiwan: 00.801.137.737
Thailand: 001.800.120.665853
Other Countries: +65.6220.4666